

CODE: **AWO453** v1.5/III  
 NAME: **EXPANDER 2**

EN

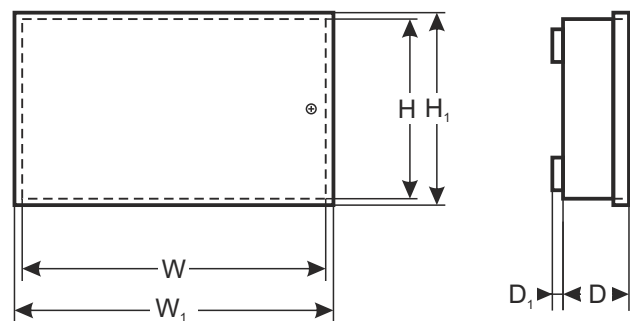

## DESTINATION

**DSC:**  
**Power Series Neo**  
 Modules: HSM2300, HSM2204, HSM2208, HSM2108, PCL-422

**Power Series**  
 Moduly / modules: PC5320, PC5100, PC5108, PC4216, PC5200, PC5204, PC5400, IT-100.

**Power Series Pro**  
 Modules: HSM3408, HSM2108, AMX-400.

**PARADOX:**  
 Modules: ZX4, ZX8, ZX8SP, APR3-HUB2, PGM4.

**RISCO:**  
 Modules: EZ8, EZ16

**SATEL:**  
 Modules: CA-64 PTSA, CA-10 E, ETHM-1 Plus, INT-ADR, INT-AV, INT-E, INT-FI, INT-GSM, INT-KNX-2, INT-O, INT-PP, INT-R, INT-RS Plus, INT-VG, INT-VMG, MST-1.

*Documentation shows which devices can be installed in a given enclosure. It does not define how many different devices can be installed in one enclosure. Number of installed devices depends on their size and arrangement*

## TECHNICAL DATA

<b>External dimensions of enclosure:</b>	W=262, H=172, D+D <sub>1</sub> =49+8 [+/- 2mm]
<b>External dimensions of flange:</b>	W <sub>1</sub> =267, H <sub>1</sub> =176 [+/- 2mm]
<b>Net/gross weight:</b>	0,853 / 0,940 [kg]
<b>Operating conditions:</b>	II environmental class, -10°C+ 40°C
<b>Material:</b>	sheet steel DC01, thickness: 0,7mm, protection anticorrosion, color: RAL 9003
<b>Destination:</b>	indoor
<b>Tamper protection:</b>	1 x microswitch: opening, 0,5 A@50 V DC max. NC - normally closed contacts
<b>Closing:</b>	screwed: screw x 1
<b>Notes:</b>	distance from wall (mounting surface) - 8mm
<b>Declaration, warranty:</b>	CE, 2 years from production date